

Send original copy by certified mail to the Texas Water Development Board P. O. Box 12386 Austin, Texas 78711

State of Texas WATER WELL REPORT

For TWDB use only Well No. Located on map Received: Form GW 8 Form GW 9

1) OWNER: Person having well drilled Hog Creek Water Supply Corporation Well No 1 Address Valley Mills, Texas Landowner same

2) LOCATION OF WELL: McLennan County Bosque Labor League Abstract No. NW 1/4 NE 1/4 SW 1/4 SE 1/4 of Section Block No. Survey

5 miles in W direction from Valley Mills, Texas (NE, SW, etc.) (Town)

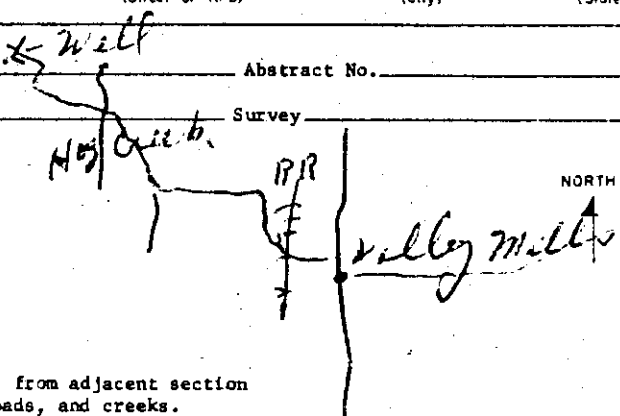

Sketch map of well location with distances from adjacent section or survey lines, and to landmarks, roads, and creeks.

3) TYPE OF WORK (Check): New Well [X] Deepening [] Reconditioning [] Plugging [] 4) PROPOSED USE (Check): Domestic [] Industrial [] Municipal [X] Irrigation [] Test Well [] Other [] 5) TYPE OF WELL (Check): Rotary [X] Driven [] Dug [] Cable [] Jetted [] Bored []

6) WELL LOG: Diameter of hole 11 in. Depth drilled 1194 ft. Depth of completed well 1194 ft. Date drilled Oct. 1969 All measurements made from 0 ft. above ground level.

Table with 3 columns: From (ft.), To (ft.), Description and color of formation material. Rows include soil, chunk rock, white rock, shale, sandy lime, sand, red bed, sand.

Table with 3 columns: From (ft.), To (ft.), Description and color of formation material. Includes note: (Use reverse side if necessary)

7) COMPLETION (Check): Straight wall [X] Gravel packed [] Other [] Under reamed [] Open hole []

8) WATER LEVEL: Static level 374 ft. below land surface Date Oct. 1969 Artesian pressure lbs. per square inch Date

9) CASING: Type: old [] New [X] Steel [X] Plastic [] Other [] Cemented from 925 ft. to top ft. 300 sks of cement

10) SCREEN: Type torch Perforated [] Slotted [X]

Table with 4 columns: Diameter (inches), Setting From (ft.), To (ft.), Gage. Row: 7" OD, 925, top

Table with 4 columns: Diameter (inches), Setting From (ft.), To (ft.), Slot size. Row: 4 1/2" OD, 992, 1112, slotted

11) WELL TESTS: Was a pump test made? [X] Yes [] No If yes by whom? Tom Smith Yield: 120 gpm with 458 ft. drawdown after 24 hrs Bailer test gpm with ft. drawdown after hrs Artesian flow gpm Date Temperature of water Was a chemical analysis made? [X] Yes [] No Did any strata contain undesirable water? [] Yes [X] No Type of water? good soft depth of strata

12) PUMP DATA: Manufacturer's Name Type H.P. Designed pumping rate gpm gph Type power unit Depth to bowls, cylinder, jet, etc., ft. below land surface.

I hereby certify that this well was drilled by me (or under my supervision) and that each and all of the statements herein are true to the best of my knowledge and belief. NAME C. M. Stoner Water Well Drillers Registration No. 17 Address Rt. 4 Box 157 Cleburne, Texas (Signed) C. M. Stoner Stoner Drilling Co.

Please attach electric log, chemical analysis, and other pertinent information, if available.

| FROM (ft) | TO (ft) | FORMATION |
|--------------|------------|-----------------|
| 0 | 1 | soil |
| 1 | 4 | chunk rock |
| 4 | 880 | white rock |
| 880 | 900 | shale |
| 900 | 925 | sandy lime |
| 925 | 950 | sand |
| 950 | 994 | red bed |
| 994 | 1112 | sand |
| 1112 | 1194 | red sandy shale |