



SOUTHERN TRINITY GROUNDWATER CONSERVATION DISTRICT
COUNTY OF MCLENNAN, STATE OF TEXAS

HISTORIC USE PRODUCTION PERMIT

THIS CERTIFIES THAT: City of Moody
606 Ave. E.
Moody, Texas 76557
Phone: 254-853-2314

(the "Permittee"), has applied for an Historic Use Production Permit to withdraw and place to beneficial use groundwater from within the District, and that the Board of Directors of the Southern Trinity Groundwater Conservation District ("District") has APPROVED the application as follows:

1 Permit Category

This permit is a **Historic Use Production Permit.**

2 Permit Term

The term of this permit is **perpetual.**

3 Groundwater Source

The source of groundwater is the **Trinity Aquifer.**

4 Annual Groundwater Withdrawal Amounts

Permittee may withdraw groundwater from the Trinity Aquifer for beneficial, nonwasteful use in a manner not to exceed the following volume: **61,5005 Acre-Foot (20,040,000 Gallons) per calendar year.** This groundwater withdrawal amount has been calculated pursuant to Section 5.211 of the District's rules. It may be subject to proportional adjustment pursuant to Chapter 5, Subchapter B of the District's rules, as may be amended.

5 Purpose of Use

Permittee may use Trinity Aquifer groundwater only for **municipal purposes.**

6 Well Name(s), Location(s), and Maximum Rate of Withdrawal

Groundwater may only be withdrawn from the aquifer from a well(s) located at each of the location(s) and with a maximum rate of withdrawal(s) (flow rate) as follows:

<u>Name</u>	<u>Location (latitude/longitude)</u>	<u>Maximum Flow Rate</u>
Well # 1	N31D 18M 28S / W97D 21M 27S	160 gpm
Well # 2	N31D 18M 17S / W97D 21M 31S	130 gpm

**SOUTHERN TRINITY GROUNDWATER CONSERVATION DISTRICT
COUNTY OF MCLENNAN, STATE OF TEXAS**

7 Measurement of Amount of Groundwater Withdrawn

Permittee may only withdraw groundwater from a well that has an operating flow meter that meets the requirements of Chapter 8 of the District's rules.

8 Place of Use

Permittee may beneficially use Aquifer groundwater only within the Permittee's wholesale or retail water service area identified in the Certificate of Convenience and Necessity 10021, filed with the Texas Commission on Environmental Quality. Except as provided by 5.401(b) of the District's rules, as may be amended, if the place of use is not within the District's boundaries, Permittee must obtain a groundwater exportation permit from the District prior to the withdrawal of groundwater under the permit.

9 Well Construction, Operation, Maintenance, Closure

The well(s) identified in this permit shall be installed, equipped, operated, maintained, plugged, capped, or closed, as may be appropriate in accordance with the District's rules and all other applicable federal, state, and local laws, including by submitting a copy of a state plugging report to the District within 60 days after capping or plugging any well.

10 Water Conservation

Withdrawals of groundwater are required to be efficiently withdrawn and used in compliance with the District's rules and the District's water conservation plan, as may be amended, and Permittee's plan as approved by the District, as may be applicable.

11 Conveyance to Place of Use

Water authorized by this permit to be produced must be conveyed to the place of use in a manner to prevent evaporation, channel loss by percolation, or waste. Water conveyed greater than a distance of one-half mile from the wellhead where produced must be conveyed through a pipeline.

12 Meters; Alternative Measuring Method

Permittee shall install, operate and maintain the meter or alternative measuring method on the well(s) identified in this permit in compliance with the District's rules and the manufacturer's instructions.

13 Reports

Permittee shall timely file all applicable reports with the District on forms prescribed by the District as required by the District's rules, as may be amended, and other applicable law.

14 Fees

Permittee shall timely pay and remain current on the payment of all applicable fees to the District.

**SOUTHERN TRINITY GROUNDWATER CONSERVATION DISTRICT
COUNTY OF MCLENNAN, STATE OF TEXAS**

15 Interruption, Suspension, or Other Limitations Due to Drought

Permittee shall reduce water supply and consumption during times of drought in accordance with the District's rules and the District's management plan and Permittee's plan approved by the District, as applicable.

16 Groundwater Management Plan

Permittee shall withdraw and use groundwater only in accordance with the District's approved groundwater management plan, as may be amended.

17 Water Quality

Permittee shall use diligence to protect the water quality of groundwater in the District and shall comply with the District's water quality rules and take no action that pollutes or contributes to the pollution of groundwater in the District.

18 Transfers and Amendments

Permittee may transfer or amend this permit only in compliance with the District's rules.

19 Permit Review, Renewal or Extension Conditions

Permittee is subject to any review, renewal or extension conditions stated in the permit or the District's rules.

20 Change of Name, Address or Telephone Number

Permittee shall provide written notice to the District of any change of ownership, name of Permittee or the authorized representative, well operator, mailing address or telephone number within 30 days of such change.

21 Inspections by District

Any authorized officer, employee, agent or representative of the District shall have the right at all reasonable times to enter upon lands upon which a well may be located within the boundaries of the District, including the well(s) identified in Paragraph 6 of this permit, for the purpose of inspecting or testing such wells, meters, pumps and the power units of a well or wells, collecting water samples, and making any other reasonable and necessary inspections and tests that may be required or necessary for the formulation or the enforcement of the permits, rules or orders of the District. Permittee has a duty to ensure that the well site is accessible to District representatives for inspection and to cooperate fully in any reasonable inspection of the well(s) and well site by District representatives.

22 Additional Conditions

This permit is issued subject to the requirements of: (1) Chapter 8821, Texas Special District Local Laws Code; (2) Chapter 36, Texas Water Code, as may be amended; and (3) the District's Rules, as may be amended.

**SOUTHERN TRINITY GROUNDWATER CONSERVATION DISTRICT
COUNTY OF MCLENNAN, STATE OF TEXAS**

23 Enforcement

The District retains the right to take any and all enforcement actions within its legal authority to enforce compliance with the terms and conditions of this permit.

24 Continuing Jurisdiction of District

This permit is issued subject to the continuing jurisdiction of and supervision by the District, and may be amended from time to time consistent with applicable law, including if the District learns that any of the information set forth in this permit is incorrect on the date issued.

25 Permit Recordation

Within 30 days of the date of issuance of this approved permit from the District, Permittee shall record this permit with the County Clerk of every county in which the well(s) or place of use are located and provide a copy of the recorded permit to the District.

26 References to Law

Any reference in this permit to a statute, rule, or other law of any kind, that exists on the date of issuance of the permit includes all subsequent amendments and additions thereto.

27 Other Matters Denied

All other matters requested in Permittee's application that are not specifically granted by this permit are denied.

**SOUTHERN TRINITY GROUNDWATER CONSERVATION DISTRICT
COUNTY OF MCLENNAN, STATE OF TEXAS**

THIS PERMIT IS ISSUED, EXECUTED THIS 5 day of August, 2010, by the Board of Directors of the Southern Trinity Groundwater Conservation District.

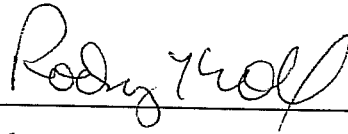

Rodney Kroll,
President, Board of Directors

ATTEST:

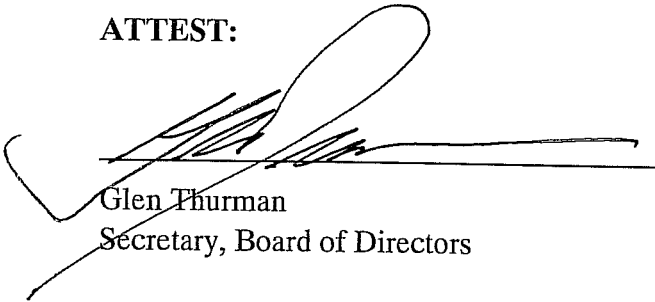

Glen Thurman
Secretary, Board of Directors

ACKNOWLEDGMENT

STATE OF TEXAS)

COUNTY OF MCLENNAN)

ON BEHALF OF THE DISTRICT, THIS PERMIT WAS ACKNOWLEDGED before me on August 5, 2010, by Rodney Kroll, President, Board of Directors, Southern Trinity Groundwater Conservation District, a groundwater conservation district created pursuant to Article XVI, Section 59, Texas Constitution.



Notary Public in and for the State of Texas

AFTER RECORDING RETURN TO:

Tricia Law, General Manager
Southern Trinity Groundwater Conservation District
P. O. Box 2205
420 North 6th Street
Waco, Texas 76703



FILED AND RECORDED
OFFICIAL PUBLIC RECORDS

J.A. Andy Harwell

August 06, 2010 01:03:59 PM

2010024361

FEE: \$27.00

J.A. "Andy" Harwell County Clerk
McLennan County TEXAS

[Faint, illegible text]

City of Moody

AFFIDAVIT

THE STATE OF TEXAS

§
§
§

COUNTY OF MCLENNAN

BEFORE ME, the undersigned authority, on this day personally appeared Michael Aycock, who being duly sworn, upon oath deposes and says:

“My name is Michael Aycock. I am over 18 years of age, competent to make this affidavit, and am familiar with the facts herein stated and believe them to be true.

I have complied with the requirements of the Southern Trinity Groundwater Conservation District’s Rules to provide notification by first class mail to landowners, well owners and well operators within one half-mile of the well or wells for which I or the entity I represent seek(s) a Historic Use Production Permit. Such notification was made not less than 10 days before the public hearing scheduled to consider the application for a Historic Use Production Permit.”

Michael Aycock
Affiant

Sworn to and subscribed before me on this 23 day of July, 2010.

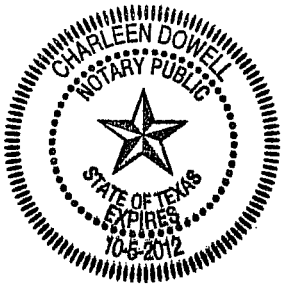

Charleen Dowell
Notary Public in and for the State of Texas

**NOTICE OF PROPOSED HISTORIC USE PRODUCTION PERMITS
AND PUBLIC HEARING**

The Southern Trinity Groundwater Conservation District ("District") proposes action on applications for Historic Use Production Permits ("HUPPs"), which would authorize the permittees to withdraw groundwater from the Trinity Aquifer according to the terms and conditions set forth in the permits. A copy of the general manager's proposed action, the proposed HUPPs and technical summaries are available for public inspection at the District's offices at 420 North 6th Street, Waco, Texas during regular business hours.

The District will conduct a public hearing pursuant to its authority under Chapter 8821 of the Texas Special District Local Laws Code, Chapter 36 of the Texas Water Code and the District's rules, to consider issuance of the proposed HUPPs and to provide interested members of the public the opportunity to appear and provide oral or written comments to the District regarding the proposed permits at the following date, time and place:

Date: Thursday, August 5, 2010
Time: 9:00 a.m.
Location: City of Woodway, City Council Chambers
922 Estates Drive
Woodway, Texas

HUPPs are proposed to be granted to the following entities as follows:

Spring Valley Water Supply Corporation, P.O. Box 399, Lorena, Texas, 76655 filed an application on 4/12/2010. The proposed HUPP has a maximum annual withdrawal of 62.5930 Acre-Feet (20,396,000 Gallons) for municipal use pumped from wells located at the following latitude/longitude (NAD83):N31D 39M 052S / W97D 30M 79S, N31D 41M 100S / W97D 25M 89S.

M.S. Water Supply Corporation, 510 N Memorial St., Riesel, Texas, 76682 filed an application on 4/14/2010. The proposed HUPP has a maximum annual withdrawal of 23.3051 Acre-Feet (7,594,000 Gallons) for municipal use pumped from wells located at the following latitude/longitude (NAD83):N31D 44.591/W097D 15.530.

Levi Water Supply Corporation, 2757 Rosenthal Pkwy, Lorena, Texas, 76655 filed an application on 4/16/2010. The proposed HUPP has a maximum annual withdrawal of 204.0709 Acre-Feet (66,496,700 Gallons) for municipal use pumped from wells located at the following latitude/longitude (NAD83):N31D 23M 19S / W97D 6M 51S, N31D 23M 33S / W97D 09M 44S, N31D 23M 21S / W97D 10M 24S.

City of Bruceville-Eddy, 143 Wilcox Dr., Eddy, Texas, 76524 filed an application on 4/26/2010. The proposed HUPP has a maximum annual withdrawal of 348.2604 Acre-Feet (113,481,000 Gallons) for municipal use pumped from wells located at the following latitude/longitude (NAD83):N31D 22M 2S / W97D 13M 29S, N31D 22M 2S / W97D 13M 28S, N31D 19M 2S / W97D 18M 22S, N31D 17M 47S / W97D 15M 13S.

Leroy-Tours-Gerald Water Supply Corporation, 312 W. Commerce, Leroy, Texas, 76654 filed an application on 4/29/2010. The proposed HUPP has a maximum annual withdrawal of 167.0067 Acre-Feet (54,419,300 Gallons) for municipal use pumped from

wells located at the following latitude/longitude (NAD83):N31D 43.851/W097 01.177, N31D 44M 13S / W97D 02M 33S, N31D 42M 27S / W97D 04M 11S.

City of Bellmead, 3015 Bellmead Dr., Bellmead, Texas, 76705 filed an application on 4/30/2010. The proposed HUPP has a maximum annual withdrawal of 1476.9910 Acre-Feet (481,279,000 Gallons) for municipal use pumped from wells located at the following latitude/longitude (NAD83):N31D 35M 45S / W97D 5 M 48S, N31D 36M 8S / W97D 05M 10S, N31D 37M 8S / W97D 05M 32S, N31D 35M 35S / W97D 06M 26S.

Pure Water Supply Corporation, P.O. Box 154414, Waco, Texas, 76715 filed an application on 4/30/2010. The proposed HUPP has a maximum annual withdrawal of 84.4251 Acre-Feet (27,510,000 Gallons) for municipal use pumped from wells located at the following latitude/longitude (NAD83):N31D 40.058/W097D 04.981, N31D 39.689/W097D 03.536.

City of Moody, 606 Ave. E., Moody, Texas, 76557 filed an application on 4/30/2010. The proposed HUPP has a maximum annual withdrawal of 61.5005 Acre-Feet (20,040,000 Gallons) for municipal use pumped from wells located at the following latitude/longitude (NAD83):N31D 18M 47S / W97D 21M 454S, N31D 18M 278S / W97D 21M 518S.

Ross Water Supply Corporation, P.O. Box 202, Ross, Texas, 76640 filed an application on 4/30/2010. The proposed HUPP has a maximum annual withdrawal of 256.4577 Acre-Feet (83,567,000 Gallons) for municipal use pumped from wells located at the following latitude/longitude (NAD83):N31D 43M 05S / W97D 07M 09S, N31D 43M 47S / W97D 05M 59S, N31D 42M 53S / W97D 07M 04S.

McLennan County WCID No. 2, P.O. Box 116, Elm Mott, Texas, 76640 filed an application on 5/3/2010. The proposed HUPP has a maximum annual withdrawal of 258.7532 Acre-Feet (84,315,000 Gallons) for municipal use pumped from wells located at the following latitude/longitude (NAD83):N31D 39M 75S / W97D 06M 26S, N31D 40M 43S / W97D 05M 36S, N31D 40M 50S / W97D 06M 32S.

EOL Water Supply Corporation, 9226 Elk Road, Axtell, Texas, 76624 filed an application on 5/3/2010. The proposed HUPP has a maximum annual withdrawal of 214.7877 Acre-Feet (69,988,800 Gallons) for municipal use pumped from wells located at the following latitude/longitude (NAD83):N31D 35M 18S / W96D 59M 08S, N31D 36M 55S / W96D 56M 13S, N31D 35M 36S / W96D 58M 28S.

Elm Creek Water Supply Corporation, P.O. Box 538, Moody, Texas, 76557 filed an application on 5/3/2010. The proposed HUPP has a maximum annual withdrawal of 225.3186 Acre-Feet (73,420,300 Gallons) for municipal use pumped from wells located at the following latitude/longitude (NAD83):N31D 17M 18S / W97D 18M 44S, N31D 19M 17S / W97D 23M 17S, N31D 15M 24S / W97D 47M 17S.

Patrick Water Supply Corporation, 245 Goldman Lane, Waco, Texas, 76708 filed an application on 5/3/2010. The proposed HUPP has a maximum annual withdrawal of 52.5578 Acre-Feet (17,126,000 Gallons) for municipal use pumped from wells located at the following latitude/longitude (NAD83):N31D 41M 09S / W97D 14M 78S.

Gholson Water Supply Corporation, 12520 Gholson Rd., Waco, Texas, 76705 filed an application on 5/3/2010. The proposed HUPP has a maximum annual withdrawal of 270.0348 Acre-Feet (87,991,100 Gallons) for municipal use pumped from wells located at the following latitude/longitude (NAD83):N31D .44.417./ W097D 15.223, N31D

43.851/ W097D 14.632, N31D 44.591/ W097D 15.530.

Hog Creek Water Supply Corporation, 147 Hsih Prairie Rd., Valley Mills, Texas, 76689 filed an application on 4/30/2010. The proposed HUPP has a maximum annual withdrawal of 81.5047 Acre-Feet (26,558,400 Gallons) for municipal use pumped from wells located at the following latitude/longitude (NAD83):N31D 36.880/W097D 31.806, N31D 29.799/W096D 58.105.

City of West, 110 N Reagan St., West, Texas, 76691 filed an application on 3/10/2010. The proposed HUPP has a maximum annual withdrawal of 465.3691 Acre-Feet (151,641,000 Gallons) for municipal use pumped from wells located at the following latitude/longitude (NAD83):N31D 48M 58S / W97D 05M 33S.

HUPP applicants or affected persons may file a written request for a contested case hearing on the proposed HUPPs with the District by no later than August 2, 2010 at 9:00 a.m. If no timely requests for contested case hearing are filed, the applications will be presented to the District on the date of the hearing for final action.

ISSUED THIS 16th DAY OF July 2010.

Tricia K. Law, General Manager
Southern Trinity Groundwater Conservation District

SOUTHERN TRINITY GROUNDWATER CONSERVATION DISTRICT

P. O. Box 2205
 420 North 6th Street
 Waco, Texas 76703

Phone: (254) 759-5610 southerntrinitygcd@att.net

APPLICATION FOR HISTORIC USE PRODUCTION PERMIT

Part A – General Information

Instructions: Please type or print legibly. Incomplete applications will not be accepted. Application Fee Required: A non-refundable application fee of \$1,000 must accompany this application. Only checks or money orders made payable to “Southern Trinity Groundwater Conservation District” will be accepted. CASH IS NOT ACCEPTED.

1. Applicant Information			<input type="checkbox"/> Individual	<input type="checkbox"/> Partnership	<input type="checkbox"/> Corporation
			<input checked="" type="checkbox"/> Government Entity	<input type="checkbox"/> Estate/Trust/Guardianship	
Permit Applicant's Name: <u>City of Moody</u>					
Physical Address: <u>606 Ave. E</u>					
City: <u>Moody</u>		State: <u>TX</u>		Zip Code: <u>76557</u>	
Mailing Address, (if different): <u>P.O. Box 68</u>					
City: <u>Moody</u>		State: <u>TX</u>		Zip Code: <u>76557</u>	
Daytime Telephone Number:		Fax: <u>254-853-2314</u>		<u>254-853-2614</u>	
Email Address (if any):					
2. Name of Authorized Agent (if any): <u>Michael Aycock</u>					
Position: <u>Director of Public Works</u>					
Physical Address: <u>606 Ave. E</u>					
City: <u>Moody</u>		State: <u>TX</u>		Zip Code: <u>76557</u>	
Mailing Address (if different): <u>P.O. Box 68</u>					
City: <u>Moody</u>		State: <u>TX</u>		Zip Code: <u>76557</u>	
Daytime Telephone Numbers of Authorized Agent:		Fax: <u>254-379-6869</u>		<u>254-853-2614</u>	
Email for Authorized Agent (if any): <u>Mike Aycock@VVM.com</u>					
<div style="border: 1px solid black; padding: 5px; width: fit-content; margin: auto;"> RECEIVED Date Application Received: <u>APR 30 2010</u> BY: <u>[Signature]</u> </div>		For District Use Only Date Admin. Fee Received:		<div style="border: 1px solid black; padding: 5px; width: fit-content; margin: auto;"> RECEIVED Amount of Fee: <u>APR 30 2010</u> BY: <u>[Signature]</u> </div>	

X

Historic Groundwater Use and Production Information.

3. Purpose of Historic Use: The purpose(s) for which the groundwater was used during the Historic Use Period. Irrigation Municipal Industrial
 Other (If Other, describe specifically):

4. Purpose of Future Use: *Municipal*

5. Is the place of use within the District boundaries: Yes No

6. If you answered No to Item 5, has a groundwater exportation permit been applied for or obtained from the District or is there a groundwater export agreement or contract in effect prior to January 7, 2010? Yes No

7. If you answered Yes to Item 6, please describe the parties to the agreement, the location outside of the District that the water is used, the amount use, and pipeline route.

8. Completely describe the place of use of groundwater withdrawn from the well:

City of Meedy water system

9. If groundwater was withdrawn from the well or placed to a beneficial use by a contract user or predecessor in interest, then provide the name, address, and telephone number of each contract user or predecessor in interest, and provide copies of the legal documents establishing the legal right of the contract user or predecessor in interest to withdraw and/or place groundwater from the well to beneficial use.

10. If applicable, provide a copy of the map identifying the boundaries of the applicant's Certificate of Convenience and Necessity (CCN).

11. If applicable, describe the number of connections to be serviced by the well: *700*

12. Maximum Historic Use. State the amount of water that you claim as your Maximum Historic Use during any one year of the Historic Use Period. Maximum Historic Use means the maximum amount of groundwater that an applicant for a Historic Use Production Permit proves was produced and beneficially used without waste from the applicant's non-exempt well during any one calendar year of the Historic Use Period.

Amount: *20,040,000* Units: *Gallons* Year: *2003*

13. Provide your use amounts for each year groundwater was withdrawn during the Historical Use Period. If no groundwater was withdrawn for a period listed below, place a zero (0) in the appropriate space (typical units are in gallons, 100 gallons, 1000 gallons, or acre-feet).

2009	Amount:	7,523,300	Units:	Gallons
2008	Amount:	9,363,100	Units:	Gallons
2007	Amount:	2,752,100	Units:	Gallons
2006	Amount:	12,175,500	Units:	Gallons
2005	Amount:	11,310,000	Units:	Gallons
2004	Amount:	7,136,400	Units:	Gallons
2003	Amount:	20,040,000	Units:	Gallons
2002	Amount:	15,954,000	Units:	Gallons
2001	Amount:	3,300,500	Units:	Gallons
2000	Amount:	9,465,400	Units:	Gallons

14. Attach documents to substantiate your claim of Maximum Historic Use.

Documentation may include, but is not limited to: production logs showing amount of water pumped, copies of reports to the Texas Commission on Environmental Quality, the Texas Water Development Board, or the Texas Department of Health; reports filed with or created by the Natural Resource Conservation Service or Farm Services Agency or aerial photographs; reports filed with or created by soil and water conservation districts; fuel and electricity use records; and calculations used to estimate well discharge rates if the well discharge is not metered. The purpose of supporting documentation is to substantiate your declaration. The information you provide should be labeled, indexed and in a form that can be easily reviewed by the District.

15. Will the proposed use of water unreasonably affect existing groundwater and surface water resources or existing permit holders? Yes No

16. Is the proposed use of water dedicated to a beneficial use? Yes No

17. Is the proposed use of water consistent with the District's management plan? Yes No

**STATEMENT OF COMPLIANCE WITH DISTRICT GROUNDWATER
MANAGEMENT PLAN, DISTRICT RULES, AND COMMITMENT TO WATER
CONSERVATION AND WATER QUALITY PROTECTION**

Please check all that apply:

- Applicant will comply with the District's Groundwater Management Plan.
- Applicant is in compliance with all applicable District rules in effect since December 7, 2007 and will comply with the District's rules.
- Applicant agrees to avoid waste and achieve water conservation.
- Applicant agrees to use reasonable diligence to protect groundwater quality and will follow the District's well plugging guidelines at the time of well closure.
- Applicant affirms that activities constituting the purpose of use for which the groundwater will be beneficially used will be managed to preserve, protect, prevent the pollution, degradation, or harmful alteration of, control and prevent the waste of, prevent the escape of groundwater from, and achieve the conservation of groundwater in and produced from, the aquifer.

CERTIFICATION†

I, the undersigned applicant, subscribe and affirm that the information provided herein is true and correct. I also understand that it shall be considered to be a fraud upon the District for any applicant to knowingly give erroneous information in this application.

Signed: Michael Aycock

Date: 4-15-10

Printed Name: Michael Aycock

Title: D.I. Public works

† If the applicant is an individual, the application shall be signed by the applicant or a duly appointed agent. An agent shall provide written evidence of his or her authority to represent the applicant. If the applicant is an individual doing business under an assumed name, the applicant shall attach to the application an assumed name certificate filed with the county clerk of the county in which the principal place of business is located or with the Texas Secretary of State.

A joint application shall be signed by each applicant or each applicant's duly authorized agent with written evidence of such agency submitted with the application. If a well or proposed well is owned by both husband and wife, each person shall sign the application. Joint applicants shall select one among them to act for and represent the others in pursuing the application with the District with written evidence of such representation to be submitted with the application.

If the application is by a partnership, the application shall be signed by one of the general partners. If the applicant is a partnership doing business under an assumed name, the applicant shall attach to the application an assumed name certificate filed with the county clerk of the county in which the principal place of business is located or with the Texas Secretary of State. The name of the partnership must be followed by the words "a partnership." If the applicant is an estate or guardianship, the application shall be signed by the duly appointed guardian or representative of the estate and a current copy of the letters testamentary issued by the court shall be attached to the application.

If the applicant is a corporation, public district, county, municipality or other corporate entity, the application shall be signed by a duly authorized official. Written evidence in the form of bylaws, charters, or resolutions specifying the authority of the official to take such action shall be submitted along with the application. A corporation may file a corporate affidavit as evidence of a corporate official's authority to sign.

If the applicant is acting as trustee for another, the applicant shall sign as trustee and in the application shall disclose the nature of the trust agreement and give the name and current address of each trust beneficiary. The application must designate the trustee's name followed by the word "trustee," and the name of the trust for which the trustee is acting.

Application No. _____

STATE OF TEXAS §

§

COUNTY OF §

BEFORE ME, a notary public, on this day personally appeared: Michael
Cycock who stated that: (1) he/she has read the
foregoing application and any supporting attachments and that the statements contained
therein are true and accurate; and (2) that he/she is duly authorized to sign this
application on behalf of the permit applicant.

Subscribed and sworn to before me on this 30 day of April, 2010.

Carol Haas

Notary Signature



Southern Trinity Groundwater Conservation District

P. O. Box 2205, 420 N. 6th St.
Waco, Texas 76703
254-759-5610, southerntrinitygcd@att.net

February 19, 2010

Micheal Aycock
City of Moody
P. O. Box 68
Moody, Texas 76557

VIA CERTIFIED MAIL RETURN RECEIPT: 70050390000108887019

The Board of Directors of the Southern Trinity Groundwater Conservation District ("District") has recently completed the Groundwater Management Plan and amended Rules for the District (a digital copy of the rules is on the enclosed CD-ROM disk or can be downloaded from <http://www.co.mclennan.tx.us/commis/stgwcd.aspx> or picked up from the District office at 420 N. 6th Street, Waco, Texas). Under the District Rules, all groundwater withdrawals for non-exempt uses in the District such as municipal, industrial or agricultural irrigation purposes, must be authorized by a valid Historic Use Production Permit ("HUPP"), a Non-Historic Use Production Permit ("NHUPP") or Interim Production Status. Well owners without a permit from the District will be required to cease all groundwater withdrawals. Exempt users of groundwater are required to register their well(s) with the District but no permit is required.

The State of Texas Groundwater Management Area 8 has designated 20,194 acre-feet per year as the amount of Managed Available Groundwater (MAG) available to be withdrawn from the portion of Trinity Aquifer within the District. The District's rules require that Historic Use Production Permits be issued based on the maximum amount of groundwater beneficially used in any single calendar year from 2000 through 2009.

The District's rules require all Historic users of groundwater within the District to file an administratively complete HUPP application with the District by no later than May 1, 2010, and pay the required application fee. I suggest that you file your application with the District as soon as reasonably possible so it may be reviewed for administrative completeness prior to May 1, 2010. A copy of this application is enclosed. A digital copy of the application can be downloaded at <http://www.co.mclennan.tx.us/commis/stgwcd.aspx> .

The District will hold a workshop on March 18, 2010 at 6:00 p.m. at the Hewitt Community Center at 208 Chama, Hewitt, Texas to help well owners complete their applications.

You are also encouraged to call the District office at (254) 759-5610 or email me at southerntrinitygcd@att.net to schedule a time to meet with me to review your application or to answer any questions regarding your application.

Sincerely,

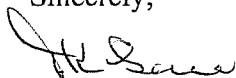

Tricia K. Law
District Administrator
Enclosures

CITY OF MOODY
UTILITY FUND
PO BOX 68
MOODY, TX 76557

FIRST NATIONAL F
MOODY, TX 765

10126

88-734/1119

04/30/2010

PAY TO THE ORDER OF SOUTHERN TRINITY G.C. D.

\$ **1,000.00

One Thousand and 00/100***** DOLLA

SOUTHERN TRINITY G.C. D.
P. O. BOX 2205
WACO, TX 76703

J. Hansen
Charlene Dowell



MEMO

⑈010126⑈ ⑆111907348⑆ ⑈01816081⑈

SECURITY FEATURES INCLUDED. DETAILS ON BACK.

RECEIPT

DATE 4/30/10 No. 248729

RECEIVED FROM City of Moody \$ 1000.00

Dwight Hansen and Charlene Dowell DOLLARS

FOR RENT
 FOR HAPP-2010-031

ACCOUNT	
PAYMENT	
BAL. DUE	

CASH
 MONEY ORDER
 CHECK
 CREDIT CARD

FROM #10126 TO _____
 BY JH

1182

STGWCD- HUPP Application - Part B – Well Information (one form per well)

1. Applicant Name: <u>City of Moody</u>	
2. Well Identifier or Well Name: <u>Well # 1</u>	
3. System Name: <u>City of Moody</u>	
4. TCEQ System ID Number: <u>1550006</u>	
5. If applicable, please attach a copy of the applicant's most recent water conservation plan and drought contingency plan prepared for TCEQ.	
6. TWDB ID Number:	
7. Aquifer(s) or formations in which the well is screened: <u>Trinity</u>	
8. Address of the property upon which the well is located:	
9. Well Location: Latitude:	<u>N 31° D 18 M 474 S</u>
	Longitude: <u>W 097° D 21 M 454 S</u>
10. Identify any surface water, including lakes or rivers within 1,000 feet of the well: <u>None</u>	
11. Well or Driller's Log. Please attach a copy of the State Well Report and, if available, any geophysical logs for the well.	
12. Please attach a photograph of the well taken approximately 100 feet from the well.	
13. Please attach a copy of a recorded deed or other legal document verifying the applicant's ownership of the well. Disregard this requirement if the deed was sent with your Application for Interim Production Status and there has been no change.	
14. Year well drilled: <u>1948</u> Year well completed and operational: <u>1948</u>	
15. Pump Information: Pump Make and Model: <u>Goulds model # GLLC-13</u>	
Pump power source: <input checked="" type="checkbox"/> Electric <input type="checkbox"/> Diesel <input type="checkbox"/> Natural Gas <input type="checkbox"/> Other Franklin <u>Franklin motor</u>	
Casing Material <input checked="" type="checkbox"/> Steel <input type="checkbox"/> PVC	
Size of well casing: <u>8 5/8</u> inches Inside diameter of column pipe: <u>4</u> inches	
16. The maximum rate at which water can be withdrawn from the well: <u>160</u> gpm	
17. Flow Meter Make and Model: <u>Precision 4th turbine</u>	
Serial Number: <u>99310213</u> Meter Units: <u>100 Gallon</u>	
Meter reading end of 2008: Amount: <u>124856</u> Units: Date: <u>Dec. 31, 2008</u>	
Meter reading end of 2009: Amount: <u>445052</u> Units: Date: <u>Dec. 31, 2009</u>	

STGWCD- HUPP Application - Part B – Well Information (one form per well)

1. Applicant Name:	City of Moody		
2. Well Identifier or Well Name:	well #2		
3. System Name:	City of Moody		
4. TCEQ System ID Number:	1550006		
5. If applicable, please attach a copy of the applicant's most recent water conservation plan and drought contingency plan prepared for TCEQ.			
6. TWDB ID Number:			
7. Aquifer(s) or formations in which the well is screened:	Trinity		
8. Address of the property upon which the well is located:			
9. Well Location: Latitude:	N 31° D 18	M 278	S
Longitude:	W 097° D 21	M 518	S
10. Identify any surface water, including lakes or rivers within 1,000 feet of the well:			
11. Well or Driller's Log. Please attach a copy of the State Well Report and, if available, any geophysical logs for the well.			
12. Please attach a photograph of the well taken approximately 100 feet from the well.			
13. Please attach a copy of a recorded deed or other legal document verifying the applicant's ownership of the well. Disregard this requirement if the deed was sent with your Application for Interim Production Status and there has been no change.			
14. Year well drilled:	1957	Year well completed and operational:	1957
15. Pump Information: Pump Make and Model:	Crown Model # 6L-160-14		
Pump power source:	<input checked="" type="checkbox"/> Electric	<input type="checkbox"/> Diesel	<input type="checkbox"/> Natural Gas <input type="checkbox"/> Other Franklin motor
Casing Material	<input checked="" type="checkbox"/> Steel	<input type="checkbox"/> PVC	
Size of well casing:	1 3/8 inches	Inside diameter of column pipe:	3 inches
16. The maximum rate at which water can be withdrawn from the well:	130 gpm		
17. Flow Meter Make and Model:	Precision 4" Turbine		
Serial Number:	56640515	Meter Units:	100 gallon
Meter reading end of 2008: Amount:	527530	Units:	Date: Dec 31, 2008
Meter reading end of 2009: Amount:	937250	Units:	Date: Dec. 31, 2009



Well #1

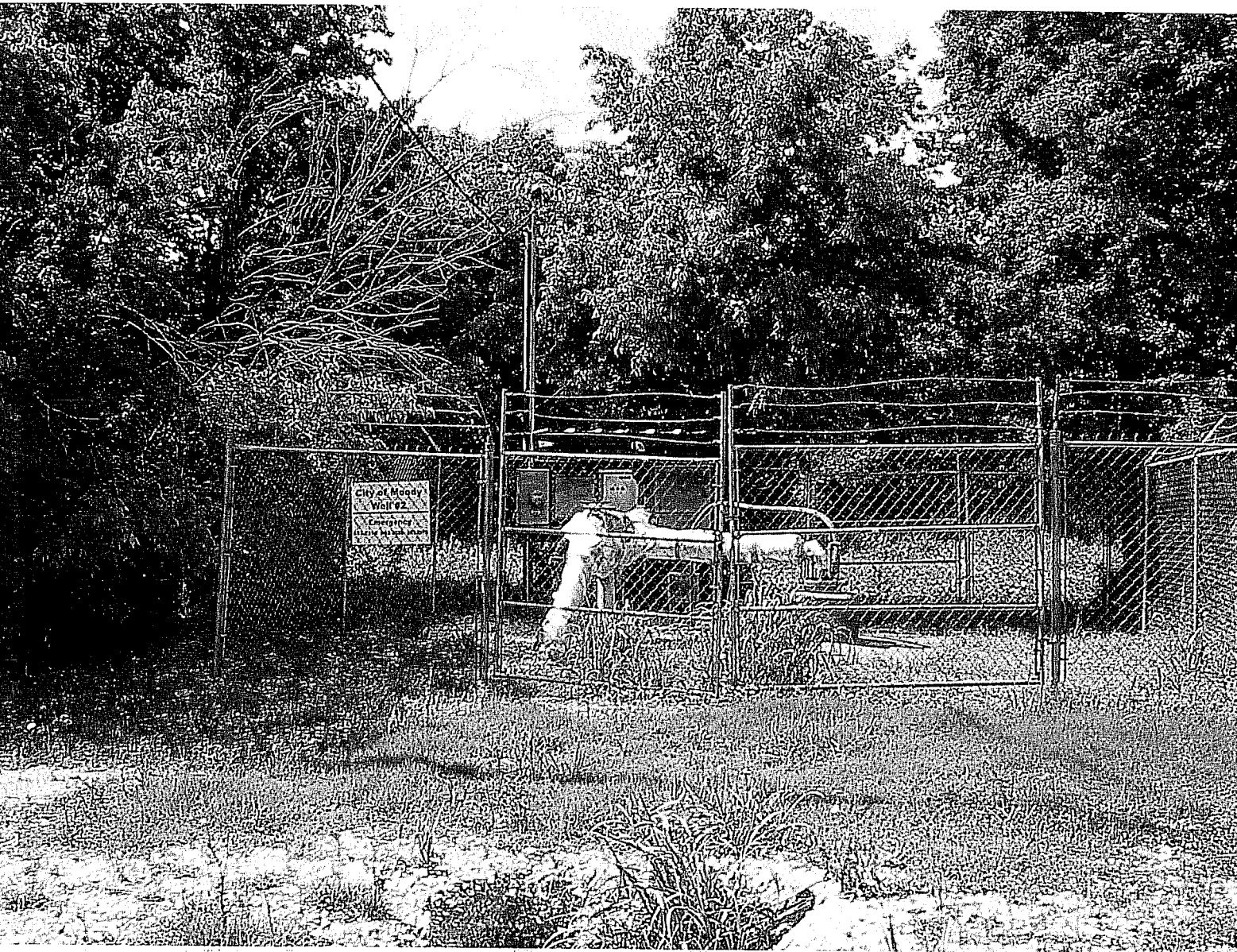

Well #2

DENTON: BOX 5105, T. C. STATION
PHONE 643 OR 2028
DEWITT MYERS

DALLAS: 5306 HARRY HINES BLVD.
PHONE LOGAN 6-5238
R. F. MYERS

PUMPS, WINDMILLS
TANKS AND PIPE

J. L. MYERS AND SONS

WATER WELL CONTRACTORS

DENTON OFFICE AND YARD
1909 HIGHLAND ST.

DENTON, TEXAS

WELLS & PUMPS REPAIRED
TURBINES A SPECIALTY

May 18, 1949

Drillers Log of

Water Well at Moody, Texas

Well #1 - 3

0-- 8 Surface soil
8 - 15 gravel
15 - 25 Sand and Gravel
25 - 70 Rock
70 - 83 Hard Lime
83 - 150 Hard Lime
150 - 163 Shale
163 - 243 Lime
243 - 288 Lime
288 - 303 Lime
303 - 319 Sandy Shale
319-357 Lime
357 - 440 Lime with Streaks of Shale
440 - 539 Lime and Shale
539 - 562 Lime
562 - 580 Lime
580 - 655 Lime
655 - 729 Lime
729 - 831 Lime and Shale
831 - 894 Lime
894 - 954 Lime
954 - 1018 Lime and Shale
1018 - 1085 Lime and Shale
1085 - 1118 Sand 33'
1118 - 1185 Lime
1185 - 1197 Lime
1197 - 1251 Sand - 54'
1251 - 1279 Lime
1279 - 1356 Broken Shale & Lime
1356 - 1385 Shale and Lime
1385 - 1431 Sand - 44'
1431 - 1481 Broken Sand and Lime 50'
1481-1494 Lime
1494 - Bottom of Hole

Set: 1333' of 8" Pipe, cemented with 350 sacks of cement.
Set: 187' of 6" Liner, 154' perforation, 33' blank liner.

DENTON: BOX 5105, N. T. STATION
PHONE 382-4196
DEWITT MYERS

DALLAS: 5306 HARRY HINES BLVD.
PHONE LAKESIDE 6-5238
R. F. MYERS

Well #2
J. L. MYERS SONS

WATER WELL CONTRACTORS

DENTON OFFICE AND YARD
1909 HIGHLAND STREET
DENTON, TEXAS

WELLS AND PUMPS REPAIRED

TURBINES A SPECIALTY

DRILLER'S LOG

Owner of Well: City of Moody
Well Location: Moody, McLennan County, Texas
Well Drilled By: J. L. Myers Sons - Denton & Dallas, Texas
Well Completed: July 27, 1957 Drillers: Smith & Gibbs

Depth of Strata	Thickness	Formation
0-6	6	Surface Soil
6-20	14	Clay
20-180	160	Shale
180-331	151	Chalk
331-614	283	Broken Rock & Shale
614-630	16	Shale
630-913	283	Sandy Lime
913-1039	126	Lime
1039-1100	61	Sandy Lime
1100-1215	115	Lime
1215-1434	219	Sand & Shale
1434-1495	61	Lime
1495-1550	55	Sand
1550-1561	11	Lime

Casing Record:

0-24 24' Of 20" Surface Pipe cemented in place
0-896 896' Of 13-3/8" Casing
896-898 1 - 13-3/8" X 8-5/8" Swedge
898-1320 422' Of 8-5/8" Casing

Well cemented from 1320' to Ground Level with 522 Sacks Cement

Liner Record:

1309-1347 38' Of 6-5/8" Blank Liner with Lead Seal
1347-1485 138' Of 6-5/8" Mill Slot Pipe
1485-1561 76' Of 6-5/8" Blank Liner

Total Liner 252'

Back Pressure Valve 36' off bottom

CITY OF MOODY

DAVID CULPEPPER
DIRECTOR OF PUBLIC WORKS
606 AVENUE E
P.O. BOX 68
MOODY, TEXAS 76557

Telephone 254-853-2314
Fax 254-853-2164

May 21, 2007

T.C.E.Q.

The enclosed certified CCN map was obtained from the TCEQ mailing dated May 1, 2007. If you have any questions feel free to call me at 254-853-2314.



David Culpepper



AFFIDAVIT OF CERTIFICATION

COUNTY OF McLENNAN §
§
STATE OF TEXAS §

KNOW ALL PERSONS BY THESE PRESENTS:

I, Charleen Dowell hereby certify that the attached map represents the existing Certificate of Convenience and Necessity (CCN) as defined by the Texas Commission on Environmental Quality (TCEQ) for water and sewer jurisdictions of the City of Moody and surrounding areas. Original full scale maps of the attachments may be viewed at the City Hall of the City of Moody.

Charleen Dowell

City Administrator

SWORN AND SUBSCRIBED before me on the 14th day of May, 2007

(Notary Seal)

Carol Haas

Notary Public for the
State of Texas

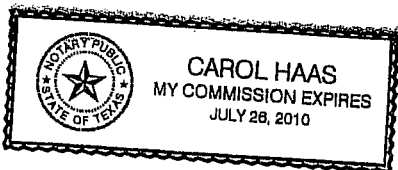

Kathleen Hartnett White, *Chairman*
Larry R. Soward, *Commissioner*
Martin A. Hubert, *Commissioner*
Glenn Shankle, *Executive Director*



TEXAS COMMISSION ON ENVIRONMENTAL QUALITY

Protecting Texas by Reducing and Preventing Pollution

December 6, 2006

Re: Requirement to File Certified Service Area Map

Dear Utility Service Provider:

House Bill 2876 passed by the 79th Legislature, amended Chapter 13 of the Texas Water Code by adding Section 13.257(r) and (s). This statute requires water and sewer utility service providers holding a certificate of convenience and necessity (CCN) to record a certified copy of their CCN map in the real property records of each county in which the service area or a portion of the service area is located by **January 1, 2007**. The certification must be done by the Texas Commission on Environmental Quality (TCEQ). A boundary description provided by the CCN holder must also be filed in the real property records as outlined by the statute. CCN holders are required to provide information to the TCEQ that verifies that the county filing requirement has been met. For your reference, a copy of Water Code 13.257(r) and (s) is located on the back of this letter.

To assist you in meeting this requirement, the TCEQ has used its Financial, Managerial and Technical (FMT) Assistance Contractor, the Texas Rural Water Association (TRWA), to obtain a TCEQ-certified copy of your CCN map. The certified map(s) of your CCN area are enclosed. Some of the map(s) may be difficult to read due to age, reproduction or reduction to meet the 11" x 17" filing requirement.

After you have filed the certified copy of your map(s) with each applicable county, please send a copy of the certified, recorded CCN map(s) to the TCEQ by **January 31, 2007**, to document that the requirement has been met. Please also include a cover letter stating where the certified CCN map was obtained. For example, "the maps that were filed were obtained from the TCEQ mailing" or "we obtained the maps ourselves from central records." Please send this information to:

Texas Commission on Environmental Quality
Utilities & Districts Section, MC 153
P.O. Box 13087
Austin, Texas 78711-3087

If you have any questions about the information in this letter, please contact Ms. Tracy Harbour at 512/239-6952 or Ms. Tammy Benter at 512/239-6136. To request additional assistance through the TCEQ's FMT Assistance Contract, please contact Ms. Margot Taunton at 512/239-6403; Ms. Stacy Foster at 512/239-3105, or Ms. Elizabeth Flores at 512/239-6846. For additional information on the FMT Assistance Contract, please see the enclosed informational flyer.

Sincerely,

A handwritten signature in cursive script that reads "Doug Holcomb".

Doug Holcomb, P.E., Section Manager
Utilities & Districts Section
Water Supply Division

MDC/MT/wem

Enclosures

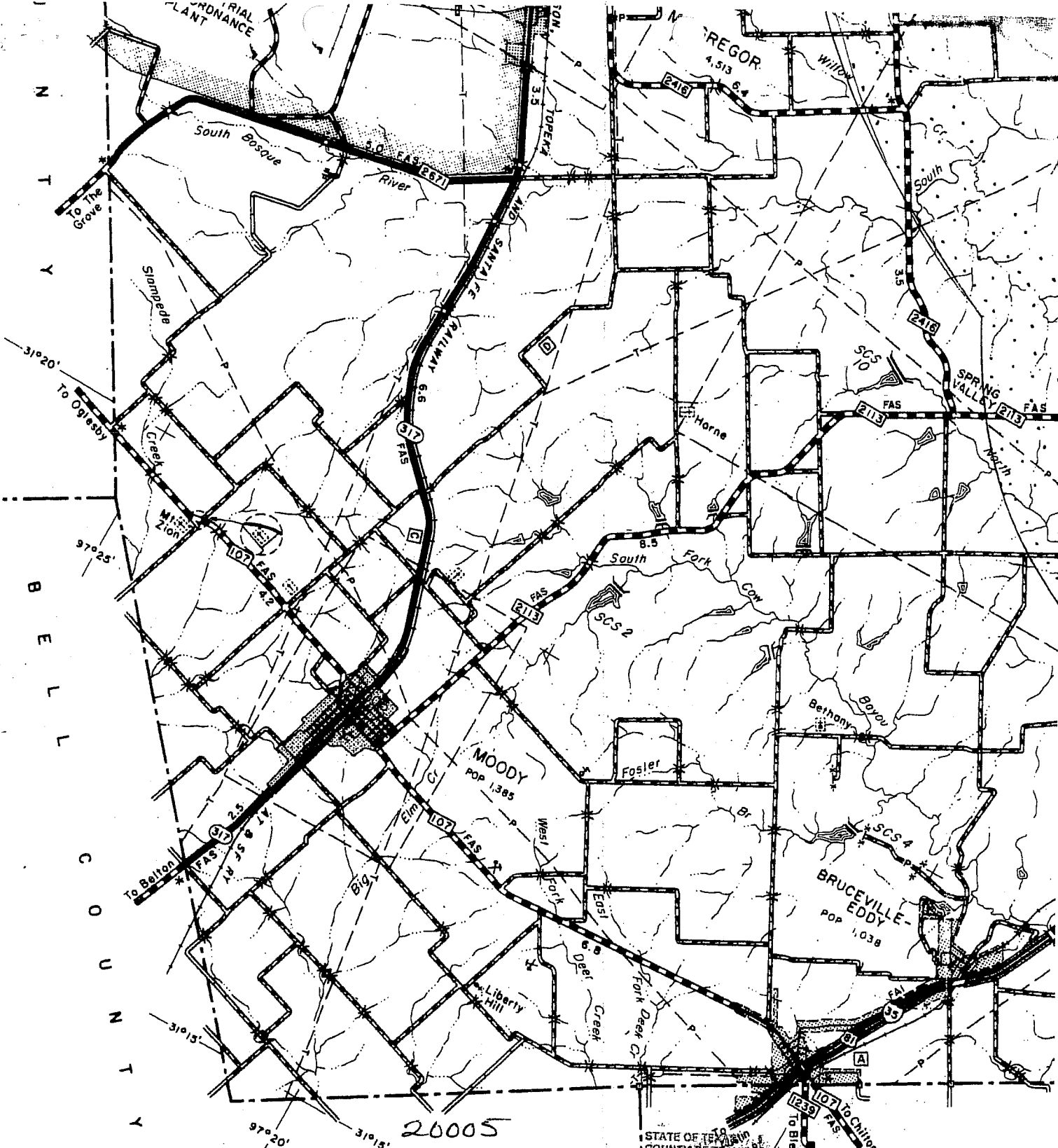

20005

BELL COUNTY

STATE OF TEXAS
 COUNTY OF DAVIS
 I HEREBY CERTIFY THAT THIS IS A TRUE AND CORRECT COPY OF
 A TEXAS COMMISSION ON ENVIRONMENTAL QUALITY (TCEQ)

MAY - 1 - 2003

DOCUMENT WHICH IS KEPT IN THE RECORDS OF THE COMMISSION, GIVEN UNDER MY HAND AND THE SEAL OF OFFICE

Rooney D. Peschel

ROONEY D. PESCHEL
 ALTERNATE CLERK OF RECORDS
 TEXAS COMMISSION ON ENVIRONMENTAL QUALITY

FILED AND RECORDED
OFFICIAL PUBLIC RECORDS

J.A. Andy Harwell

May 16, 2007 01:13:12 PM

2007017631

FEE: \$27.00

J.A. "Andy" Harwell County Clerk
McLennan County TEXAS

CITY OF MOODY

DAVID CULPEPPER
DIRECTOR OF PUBLIC WORKS
606 AVENUE E
P.O. BOX 68
MOODY, TEXAS 76557

Telephone 254-853-2314
Fax 254-853-2164

May 8, 2007

T.C.E.Q.

The enclosed certified CCN map was obtained from the TCEQ mailing dated March 31, 2007. If you have any questions feel free to call me at 254-853-2314.



David Culpepper



Kathleen Hartnett White, *Chairman*
Larry R. Soward, *Commissioner*
Martin A. Hubert, *Commissioner*
Glenn Shankle, *Executive Director*



TEXAS COMMISSION ON ENVIRONMENTAL QUALITY

Protecting Texas by Reducing and Preventing Pollution

December 6, 2006

Re: Requirement to File Certified Service Area Map

Dear Utility Service Provider:

House Bill 2876 passed by the 79th Legislature, amended Chapter 13 of the Texas Water Code by adding Section 13.257(r) and (s). This statute requires water and sewer utility service providers holding a certificate of convenience and necessity (CCN) to record a certified copy of their CCN map in the real property records of each county in which the service area or a portion of the service area is located by **January 1, 2007**. The certification must be done by the Texas Commission on Environmental Quality (TCEQ). A boundary description provided by the CCN holder must also be filed in the real property records as outlined by the statute. CCN holders are required to provide information to the TCEQ that verifies that the county filing requirement has been met. For your reference, a copy of Water Code 13.257(r) and (s) is located on the back of this letter.

To assist you in meeting this requirement, the TCEQ has used its Financial, Managerial and Technical (FMT) Assistance Contractor, the Texas Rural Water Association (TRWA), to obtain a TCEQ-certified copy of your CCN map. The certified map(s) of your CCN area are enclosed. Some of the map(s) may be difficult to read due to age, reproduction or reduction to meet the 11" x 17" filing requirement.

After you have filed the certified copy of your map(s) with each applicable county, please send a copy of the certified, recorded CCN map(s) to the TCEQ by **January 31, 2007**, to document that the requirement has been met. Please also include a cover letter stating where the certified CCN map was obtained. For example, "the maps that were filed were obtained from the TCEQ mailing" or "we obtained the maps ourselves from central records." Please send this information to:

Texas Commission on Environmental Quality
Utilities & Districts Section, MC 153
P.O. Box 13087
Austin, Texas 78711-3087

If you have any questions about the information in this letter, please contact Ms. Tracy Harbour at 512/239-6952 or Ms. Tammy Benter at 512/239-6136. To request additional assistance through the TCEQ's FMT Assistance Contract, please contact Ms. Margot Taunton at 512/239-6403, Ms. Stacy Foster at 512/239-3105, or Ms. Elizabeth Flores at 512/239-6846. For additional information on the FMT Assistance Contract, please see the enclosed informational flyer.

Sincerely,

Doug Holcomb, P.E., Section Manager
Utilities & Districts Section
Water Supply Division

MDC/MT/wem

Enclosures

AFFIDAVIT OF CERTIFICATION

COUNTY OF McLENNAN §
STATE OF TEXAS §

KNOW ALL PERSONS BY THESE PRESENTS:

I, Charleen Dowell hereby certify that the attached map represents the existing Certificate of Convenience and Necessity (CCN) as defined by the Texas Commission on Environmental Quality (TCEQ) for water and sewer jurisdictions of the City of Moody and surrounding areas. Original full scale maps of the attachments may be viewed at the City Hall of the City of Moody.

Charleen Dowell
City Administrator

SWORN AND SUBSCRIBED before me on the 3rd day of May, 2007

(Notary Seal)

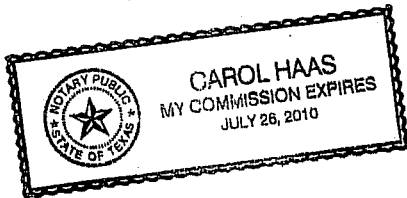

Carol Haas
Notary Public for the
State of Texas

Mail to:

City of Moody
P O Box 68
Moody Tx 76557

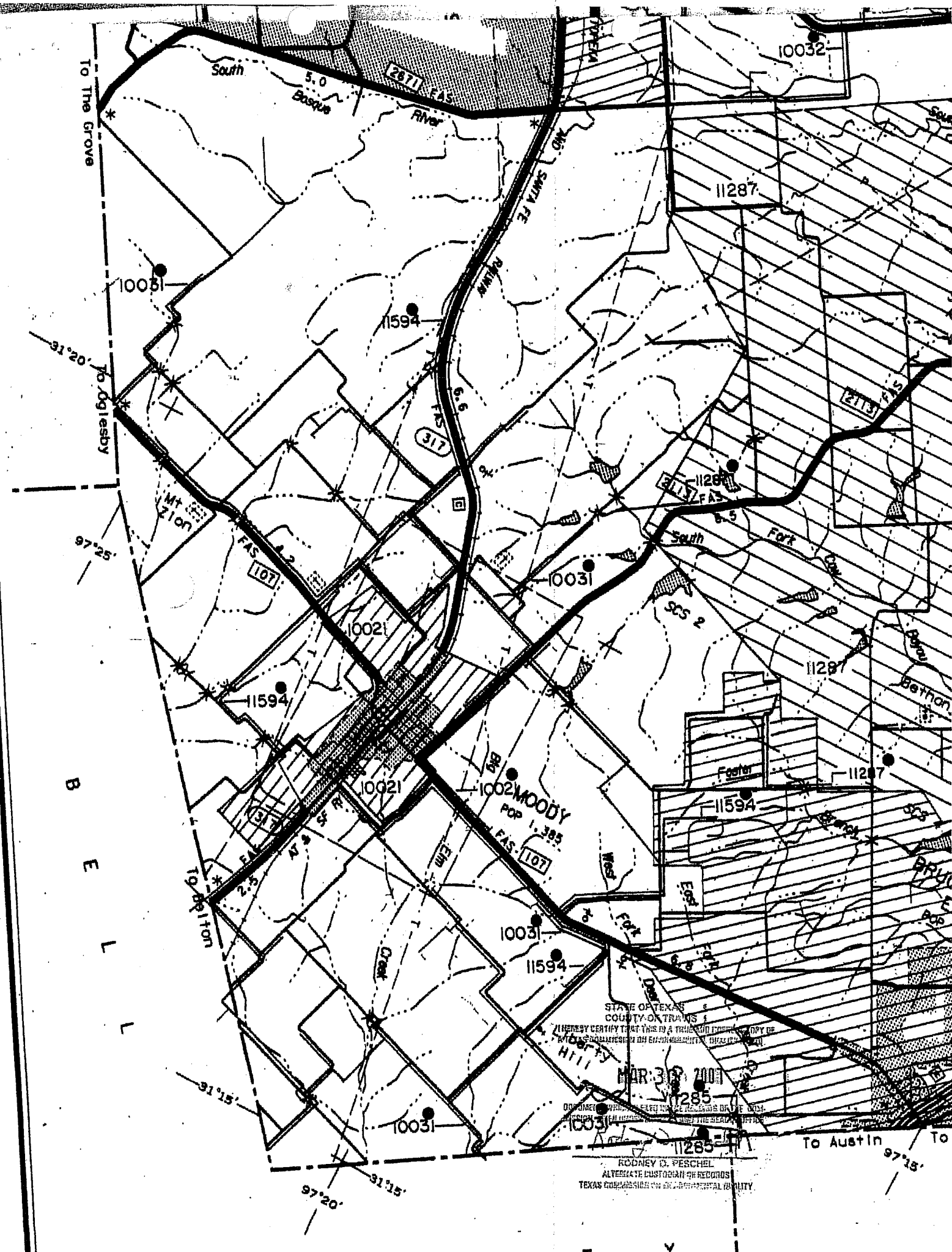

10032

11287

10031

11594

317

317 FAS

10031

MT. CREEK
2100'

107

10021

11594

10021

MOODY
POP 1,385

107

10031

11594

Foster

11594

11287

11287

STATE OF TEXAS
COUNTY OF TRAVIS
I HEREBY CERTIFY THAT THIS IS A TRUE AND CORRECT COPY OF
THE ORIGINAL RECORD AS FILED IN THE PUBLIC RECORDS OFFICE OF
THIS COUNTY ON MARCH 3, 2001.

MAR 3 2001

RODNEY G. PESCHEL
ALTERNATE CUSTODIAN OF RECORDS
TEXAS COMMISSIONERS OF GENERAL LAND OFFICE

RODNEY G. PESCHEL
ALTERNATE CUSTODIAN OF RECORDS
TEXAS COMMISSIONERS OF GENERAL LAND OFFICE

To Austin 97°15'

To The Grove

To Oglesby

B
E
L
L

To Dalton

To Austin 97°15'

Well #2



FM HIGHWAY 107 (PLATTED AS 8TH STREET)

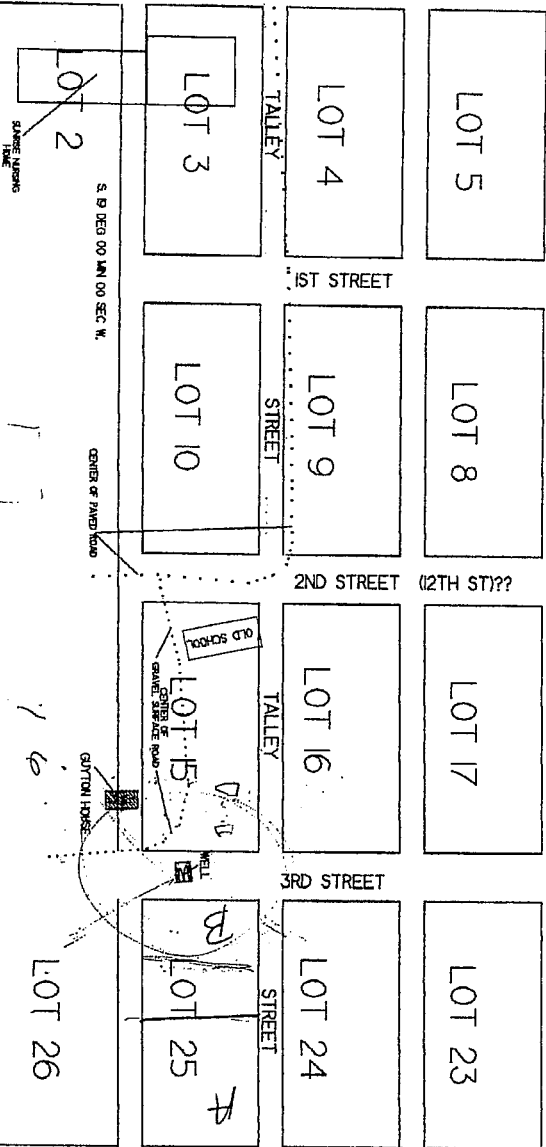

THE WELL SITE IN QUESTION IS LOCATED SOUTH 24 DEG 33 MIN 05 SEC WEST, 1098.24 FEET FROM THE CENTER OF THE INTERSECTION OF TALLEY STREET AND FM HIGHWAY 107 WHICH IS PLATTED AS 8TH STREET. TO THE BEST OF MY KNOWLEDGE, ABILITY, AND BELIEF, THE OLD WELL AND THE SURROUNDING CHAIN LINK FENCE ARE IN A PLATTED CITY STREET AND ARE ON CITY PROPERTY.

I HEREBY CERTIFY THAT I DID SURVEY THE ABOVE SHOWN PORTION OF THE A. A. COONS ADDITION TO THE CITY OF MOODY, TEXAS, AS SHOWN OF THE PLAT OF RECORD IN VOLUME 78, PAGE 296 OF THE DEED RECORDS OF MCLENNAN COUNTY, TEXAS, ON THE GROUND ON DECEMBER 15, 1998, AND THAT THE ABOVE SHOWN INFORMATION IS TRUE, CORRECT, AND ACCURATE.

HUGH A. SMITH, REGISTERED PROFESSIONAL LAND SURVEYOR, LICENSE 3567

RICE INSPECTION, INC.
 UTILITY INSPECTIONS & RIGHT OF WAY EASE

BY HUGH A. SMITH, REGISTERED PROFESSIONAL SURVEYOR, LICENSE NUMBER 3567, 2213 S. 53RD ST., TEMPLE, TEXAS 76705 (254) 770-3625 FILE

THE BEARING BASE DIRECTION WAS TAKEN FROM THE 111.11' MARKED PORTION OF THE SURVISEMENT WITH SAID SURVEY NOTES BEING OF RECORD IN VOLUME 781 AND 782 OF THE DEED RECORDS OF MCLENNAN COUNTY.

GENERAL UTILITIES COMPANY

BY H. L. Marshall
H. L. Marshall, President.

ATTEST:
J. E. Torrence
J. E. Torrence, Secretary.

(SEAL)

THE STATE OF TEXAS :
COUNTY OF McLENNAN :

BEFORE ME, a notary public in and for McLennan County,
State of Texas, on this personally appeared H. L. Marshall, known to me to
be the person whose name is subscribed to the foregoing instrument, and
acknowledged to me that he executed the same as the act and deed of General
Utilities Company, and as the president thereof, and for the purposes and
consideration therein expressed.

GIVEN UNDER MY HAND and seal of office, this 23 day
of March, 1949.

Marie C. Harrington
Notary Public in and for McLennan County,
Texas.

(SEAL)

THE STATE OF TEXAS }
COUNTY OF McLENNAN }

I, Floyd Mitchell, Clerk of the County Court and Ex-Officio
Recorder of McLennan County, Texas, do hereby certify that the

foregoing attached instrument of writing and certificate of authentication thereto, was filed in my office
for record on the 24 day of March 1949, at 1:35 o'clock A.M., and
recorded in Volume 629 on page 93 McLennan County Deed Record
on the 24 day of March 1949, at 3:45 o'clock M.

Given under my hand and seal of said Court at office in Waco, Texas, the date last above written.

FLOYD MITCHELL,
Clerk, County Court and Ex-Officio recorder, McLennan County, Texas.

By Janita Phillips Deputy.